

LIR2032

Items		Normal	Remark
Capacity	Typ.	60mAh	0.2CmA(8mA) discharge
	Min.	40mAh	
Voltage		3.7V	0.2CmA (440mA) average voltage
Internal Resistance		≤700mΩ	
Power Off Voltage		2.75V	
Charging Current		40mA	Standard charging
Maximum Charging Voltage		4.25V	
Charging Time		about2.5h	40mA charging
Maximum Charging Current		60mA	1.5CmA
Maximum Disharge Current		80mA	2.0CmA
Approximate Weight		about2.8g	
Operating Temperature and Humidity	Charging	0~+45℃	
	Discharge	-20~+60℃	
Storage Temperature	<1 month	-20~+45℃	Recommended storage temperature during transportation is at 23℃
	>6 months	-20~+35℃	

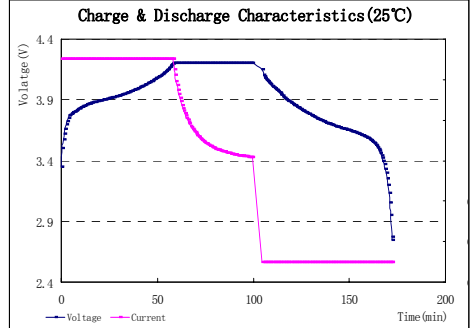

Figure 1 Charge & Discharge Characteristic

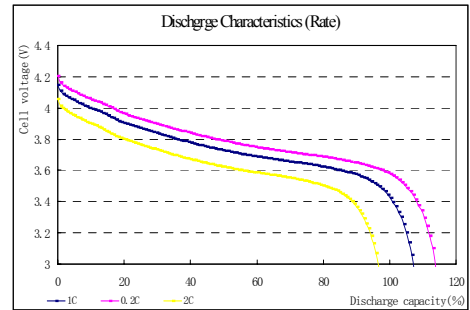

Figure 2 Discharge Characteristic

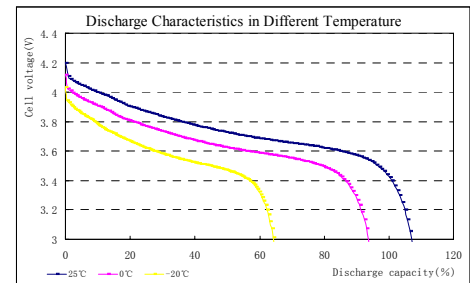

Figure 3 Discharge Characteristic in Different T

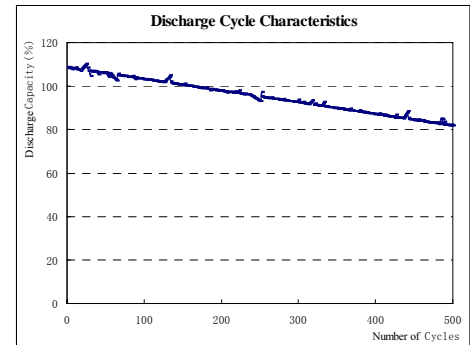
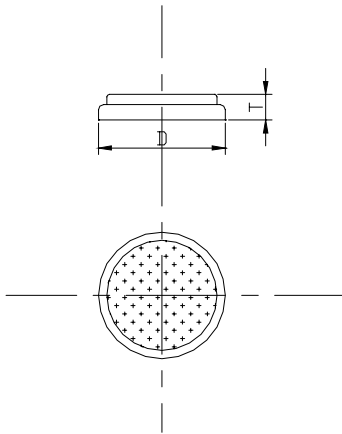

Figure 4 Discharge Cycle Characteristic



Demension	Unit
T (MAX)	3.5mm
D (MAX)	20.5mm

T: Thickness

D: Diameter